



Replacing the Contour Cut Blade

A Step By Step Guide

Replacing the Contour Cut Blade – A Step By Step Guide

The Contour Cut Blade periodically will need to be replaced as it becomes dull from use. Different materials can dull the blade at different rates and there is no set time for blade replacement. Visually you should be able to tell the difference from a dull blade from a sharp one simply by verifying the condition of the blade. A pointed blade is sharp and if the blade appears rounded or doesn't come to a sharp point, it needs to be replaced.

Some indications that the Contour Cut Blade needs to be replaced are inconsistent cut pressure, corners on graphics not cutting properly or pulling up and even cut accuracy deteriorating over a longer cut job.

Replacing the Contour Cut Blade



1. Press **MENU** and then press the **DOWN ARROW** until **SUB MENU** is reached and press the **RIGHT ARROW** to enter the **SUB MENU**



2. Press the **DOWN ARROW** until **MAINTENANCE** is reached and press the **RIGHT ARROW** to enter the **MAINTENANCE MENU**.



3. Press the **DOWN ARROW** until **REPLACE KNIFE** is reached and press the **ENTER** key to begin the process. The cutting carriage moves to a location where blade replacement is possible.



4. Preparations are complete when **FINISHED?** screen appears.

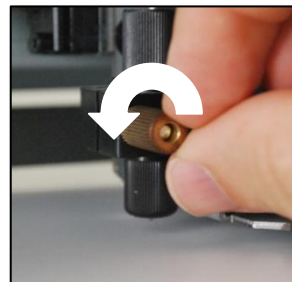

5. Remove the blade holder by turning the thumbscrew counterclockwise and lifting the blade holder out.

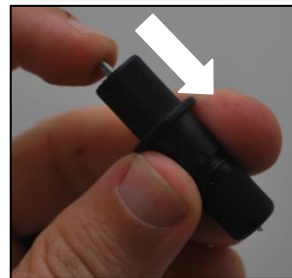

6. Press the silver plunger down and the blade will be ejected then remove the blade.

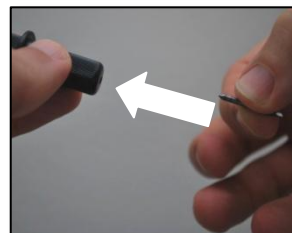

7. Install the new blade making sure that it is orientated the right direction

Continued Next Page

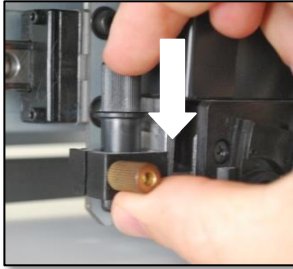

8. Support the screw from below and insert the blade holder making sure the lip on the blade holder meets the tool carriage.

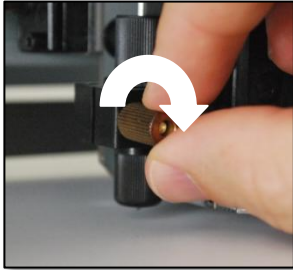

9. Turn the screw clockwise to tighten until snug.



10. Press **ENTER** to finish the replacement mode.

END DOCUMENT.