

Frequently Asked Questions Topic: PC-60 Quick-Start Guide ST80200

Roland Quick-Start Guide (Follow these simple instructions in numerical order)

NOTE: Mandatory Vinyl Preparation

It is important to have a clean surface before printing as dust and dirt can interfere with print quality. To clean the surface of the vinyl, use 91% Isopropyl alcohol or denatured alcohol and a soft dry cloth to wipe away any loose dirt or dust.

#1 Unpacking: Begin with the stand. Instructions are in the box. Once the stand is assembled, unpack the main unit. The PC-60 should be bolted to the stand before removing the packaging and tape from the unit. Make sure that all Styrofoam pieces are removed before turning on the power. Attach the media rollers to the back of the main unit once all packing materials have been removed

#2 Loading media: The pinch roller positions should be adjusted to match the media width. See figure for details. The leading edge of the media should be approximately 2 inches in front of the printing head.

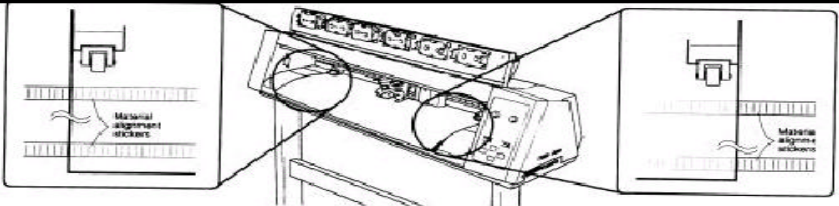

#3 Loading cartridges: Remove cartridges from box. There is a small cardboard piece to keep the cartridges taut. Remove this piece and load into any cartridge holder slot with the B side out. The Roland logo should not be visible when properly loaded. It may be necessary to re-tension cartridge ribbon after installation into the holder.

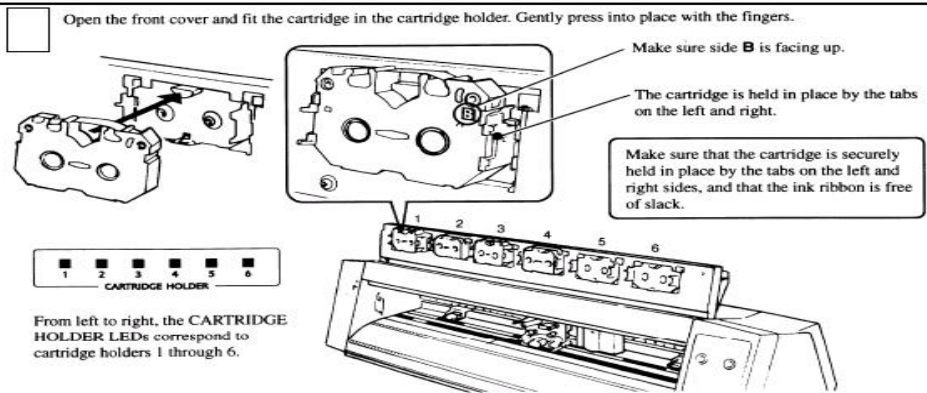

#4 Loading cutting tool: First remove the blade from its packaging. Insert the blade into the XD-CH-2 with the sharp blade out. Then loosen the brass screw on the cutter head and insert the blade holder into the plastic slot up to the shoulder of the blade holder. Tighten gently. Over-tightening can damage the screw threads. Close the front cover.

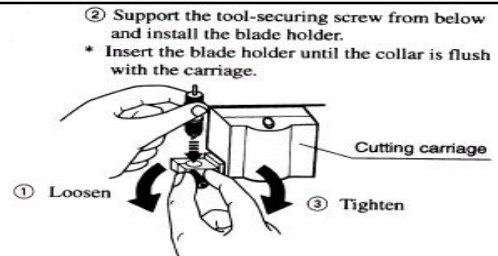

#5 Powering On: Install the power cable. Turn on the main power switch on the left side of the machine. There is a Secondary (or Sub-power) power switch on the front of the machine. To perform a self-test, press the <UP> arrow key while pressing this Secondary power switch

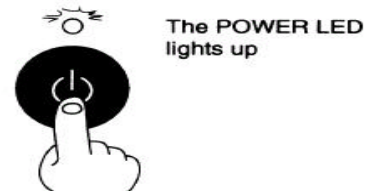

#6 Finished: Congratulations, you have successfully installed your ColorCamm PRO. To perform a print/cut test please follow the installations pictured below. Next connect the printer to your computer and consult your software manual on software installation. Setup guides for some OEM software including our Windows driver are included with this startup guide. Please consult your manual or product manufacturer for additional information.

Disclaimer: All of the information contained in this document is based on the information available at the time of its creation. In no event will Roland DGA Corporation be liable to you for any damages, including damages for loss of business profits, business interruption, loss of business information and the like arising out of the use of or inability to use these materials.